

# 3238 VICEROY CT

https://theteamjimenez.com

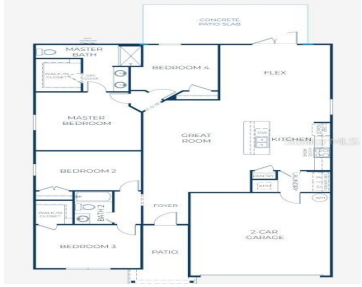

Pre-Construction. To be built. You're going to want to make The Maple at Lake Deer Estates your new home, a community where modern design meets everyday convenience in a picturesque setting. With sidewalk-lined streets and cul-de-sac streets, this neighborhood offers a peaceful and safe environment for walking, biking, and enjoying the outdoors. Surrounded by nature [...]

- 4 beds
- 2 baths
- Residential
- Single Family Residence
- Active
- 1876 sq ft



## Basics



### Call us now

Phone: (914) 230-2513  
 Email: ashley@larosainternacional.com  
 Address: 1420 Celebration Blvd. Suite 104, Celebration, FL 34747

**Category:** Single Family Residence

**Status:** Active

**Bathrooms:** 2 baths

**Total rooms:** 9

**Lot size:** 5746 sq ft

**ListOfficeName:** NEW HOME STAR FLORIDA LLC

**Zoning:** RES

**Bathrooms Full:** 2

**Flood Zone Code:** X

**Listing Contract Date:** 2025-04-27

**AdditionalRooms:** Den/Library/Office, Great Room,  
Inside Utility

**PhotosCount:** 19

**List Agent MLS ID:** 261088149

**Type:** Residential

**Bedrooms:** 4 beds

**Half baths:** 0 half baths

**Area:** 1876 sq ft

**Year built:** 2025

**Parcel Number:** 282822935720001300

**GarageSpaces:** 2

**Minimum Lease:** No Minimum

**Flood Zone Date:** 2012-09-28

**OccupantType:** Vacant

**AssociationYN:** 1

**LotSizeAcres:** 0.13

---

## Rooms



### Call us now

Phone: (914) 230-2513

Email: [ashley@larosainternacional.com](mailto:ashley@larosainternacional.com)

Address: 1420 Celebration Blvd. Suite 104, Celebration, FL 34747

| Room type           | Dimensions | Level | Length | Width |
|---------------------|------------|-------|--------|-------|
| Bedroom 2           | 14x10      | First | 10     | 14    |
| Kitchen             | 11.7x12.7  | First | 12.7   | 11.7  |
| Bedroom 3           | 14x11      | First | 11     | 14    |
| Great Room          | 14.3x23.6  | First | 23.6   | 14.3  |
| Bedroom 4           | 11.8x11.8  | First | 11.8   | 11.8  |
| Den                 | 14.8x18.1  | First | 18.1   | 14.8  |
| Balcony/Porch/Lanai | 22x10      | First | 10     | 22    |
| Laundry             |            | First |        |       |
| Primary Bedroom     | 14x14.1    | First | 14.1   | 14    |

## Building Details

**Sewer:** Public Sewer

**Foundation Details:** Slab

**Architectural Style:** Ranch

**Exterior material:** Block, Stucco

**Parking:** Driveway, Garage Door Opener

**Building Area Total:** 2358 sq ft

**Levels:** One

**New Construction YN:** Yes

**Roof:** Other, Shingle

## Amenities & Features



### Call us now

Phone: (914) 230-2513

Email: [ashley@larosainternacional.com](mailto:ashley@larosainternacional.com)

Address: 1420 Celebration Blvd. Suite 104, Celebration, FL 34747

**Features:** Eating Space In Kitchen, Living Room/Dining Room Combo, Open Floorplan, Primary Bedroom Main Floor, Smart Home, Stone Counters, Thermostat, Walk-In Closet(s)

**CommunityFeatures:** Dog Park, Pool, Sidewalks

**ExteriorFeatures:** Irrigation System, Other

**Patio & Porch Features:** Patio

**GarageYN:** Yes

**Cooling:** Central Air

**Heating:** Central, Electric

**CoolingYN:** Yes

**FireplaceYN:** No

**Amenities:** Dishwasher, Disposal, Dryer, Electric Water Heater, Microwave, Range, Refrigerator, Washer

**WindowFeatures:** Blinds, Insulated Windows, Low-Emissivity Windows

**Utilities:** Cable Available

**Waterfront available:** No

**AttachedGarageYN:** Yes

**Flooring:** Carpet, Ceramic Tile

**Laundry Features:** Laundry Room

**PoolPrivateYN:** No

---

## Nearby Schools

**Middle Or Junior School:** Lake Marion Creek Middle **Elementary School:** Laurel Elementary

**High School:** Haines City Senior High

---

## Fees and Taxes

**Association Fee Frequency:** Monthly

**Total Annual Fees:** \$3,396

**CDDYN:** -81.49683, 28.037771,

**Total Monthly Fees:** \$283



### Call us now

Phone: (914) 230-2513

Email: [ashley@larosainternacional.com](mailto:ashley@larosainternacional.com)

Address: 1420 Celebration Blvd. Suite 104, Celebration, FL 34747