

6828 WILLOW VIEW AVE

<https://theteamjimenez.com>

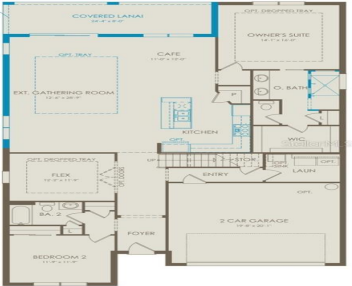

EverBe is a new master planned community where convenience and connections combine to create a new standard for home. Located in Orlando with quick access to 417 & 528, this lifestyle community will offer miles of pathways & trails, wi-fi-enabled green spaces, unique outdoor recreation areas, a fitness center, a clubhouse complex with resort pool, [...]

- 3 beds
- 2 baths
- Residential
- Single Family Residence
- Active
- 1935 sq ft



Basics



Call us now

Phone: (914) 230-2513
Email: ashley@larosainternacional.com
Address: 1420 Celebration Blvd. Suite 104, Celebration, FL 34747

Category: Single Family Residence

Status: Active

Bathrooms: 2 baths

Total rooms: 14

Lot size: 6250 sq ft

ListOfficeName: PULTE REALTY OF NORTH FLORIDA LLC

Zoning: PD/AN

Bathrooms Full: 2

Flood Zone Code: AE

OccupantType: Vacant

AssociationYN: 1

LotSizeAcres: 0.14

Type: Residential

Bedrooms: 3 beds

Half baths: 0 half baths

Area: 1935 sq ft

Year built: 2025

Parcel Number: 292331193205850

GarageSpaces: 2

Minimun Lease: 8-12 Months

Listing Contract Date: 2025-09-17

AdditionalRooms: Den/Library/Office, Loft

PhotosCount: 30

List Agent MLS ID: 261242195

Rooms



Call us now

Phone: (914) 230-2513

Email: ashley@larosainternacional.com

Address: 1420 Celebration Blvd. Suite 104, Celebration, FL 34747

Room type	Dimensions	Level	Length	Width
Great Room	12x28	First	28	12
Kitchen	10x16	First	16	10
Dinette	11x12	First	12	11
Balcony/Porch/Lanai	24x8	First	8	24
Primary Bedroom	14x16	First	16	14
Primary Bathroom	10x14	First	14	10
Bedroom 2	11x11	First	11	11
Bathroom 2	8x5	First	5	8
Laundry	8x7	First	7	8
Den	12x11	First	11	12
Loft	17x19	Second	19	17
Bedroom 4	12x12	Second	12	12
Bedroom 3	12x11	Second	11	12
Bathroom 3	9x5	Second	5	9



Call us now

Phone: (914) 230-2513

Email: ashley@larosainternacional.com

Address: 1420 Celebration Blvd. Suite 104, Celebration, FL 34747

Building Details

Sewer: Public Sewer

Building Area Total: 1935 sq ft

Foundation Details: Slab **Levels:** One

NewConstructionYN: Yes **Exterior material:** Block, HardiPlank Type, Stucco, Wood Frame

Roof: Shingle

Parking: Driveway, Garage Door Opener

Amenities & Features

Features: Eating Space In Kitchen, Kitchen/Family Room Combo, Open Floorplan, Primary Bedroom Main Floor, Smart Home, Split Bedroom, Stone Counters, Thermostat, Walk-In Closet(s)

CommunityFeatures: Clubhouse, Fitness Center, Park, Playground, Pool, Sidewalks

ExteriorFeatures: Irrigation System, Lighting, Sidewalk, Sliding Doors

Patio & Porch Features: Covered, Rear Porch

GarageYN: Yes

Cooling: Central Air

Heating: Central, Electric, Heat Pump

CoolingYN: Yes

FireplaceYN: No

Amenities: Built-In Oven, Cooktop, Dishwasher, Disposal, Electric Water Heater, Microwave

WindowFeatures: Double Pane Windows, Insulated Windows, Low-Emissivity Windows

Utilities: BB/HS Internet Available, Cable Connected, Electricity Connected, Phone Available, Public, Sewer Connected, Street Lights, Underground Utilities, Water Connected

Waterfront available: No

AttachedGarageYN: Yes

Flooring: Carpet, Luxury Vinyl, Tile

Laundry Features: Inside, Laundry Room

PoolPrivateYN: No

Nearby Schools

Middle Or Junior School: Odyssey Middle

Elementary School: Vista Lakes Elem

High School: Colonial High



Call us now

Phone: (914) 230-2513

Email: ashley@larosainternacional.com

Address: 1420 Celebration Blvd. Suite 104, Celebration, FL 34747

Fees and Taxes

Association Fee Frequency: Monthly

Total Annual Fees: \$1,524

CDDYN: -81.24781929, 28.4644858, 1

Total Monthly Fees: \$127



Call us now

Phone: (914) 230-2513

Email: ashley@larosainternacional.com

Address: 1420 Celebration Blvd. Suite 104, Celebration, FL 34747